

Facility: **Ukrainian Youth Unity Complex**

Last Updated: **09/30/2021**
Who: **SR**

Address: 9615 153 Ave NW

Contact/Caretaker: **Irene 780-232-2832**



Gym entrance door



Post and net storage



Nets setup

General Information

Parking: Players can park anywhere around the building. There are spots directly out of the main door.

Entrance/Exit: Players should enter from the gym entrance on the West side of the building. It is the single door that faces north, right behind the solid black park bench. At the end of the night, leave through the same door. The door will automatically lock at 10:30pm.

Gym Location: The gym is located directly down the hall, once inside the designated building door entrance.

Change room/Washroom: The bathrooms are attached to the gym. They can be accessed from inside the gym.

Floor: The floor is a polished floor and is great for badminton. The badminton lines are white.

Equipment

Sport Specific Equipment Location and details: The nets and posts are in a locker inside the female bathroom. They are in locker G23. Reach out the ESSC for the combination. Please put them away after games.

Gym Set-up

Badminton

Step 1: Take all pieces out of the black bags. Each piece is numbered; lay them out in chronological order.

Step 2: Connect yellow post to make a long bar, with the 'T' at the bottom.

Step 3: Connect all black poles with the angled pieces on both sides.

Step 4: The black 'T' should go right in the middle, acting as a stabilizer. If either of the yellow poles lift off the ground, the black T should be adjusted.

Step 5: Slide each side of the net onto the yellow poles and put into position.



www.EdmontonSportsClub.com
17400 116th Ave, Edmonton, AB T5B 1E6
780.429.GAME(4263)

Set-up Diagram

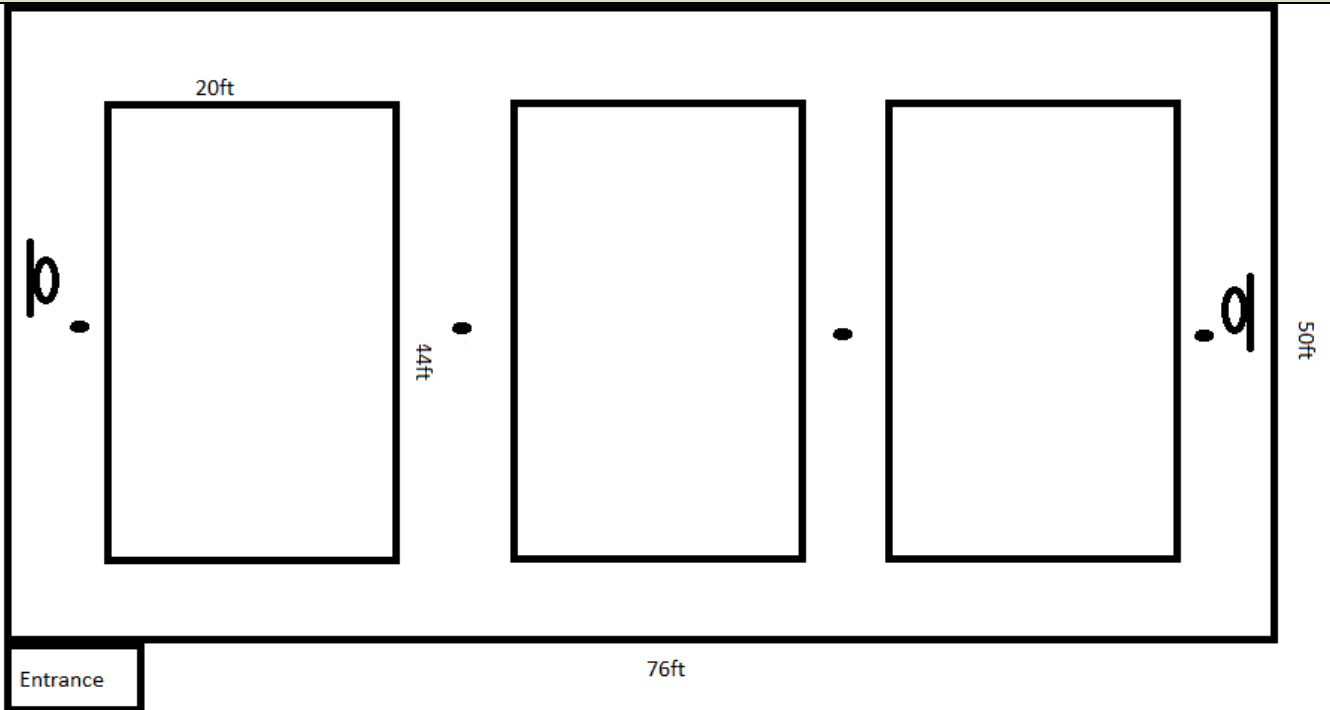

Important Notes

Ensure that outside shoes are removed at the entrance of the building.

