

Facility: **St. Joseph H.S. – Troy**

Last Updated: **Apr 26, 2024**
Who: **LC**

Address: **10830 109 St.**

Contact/Caretaker: **Hugh MacDonald**

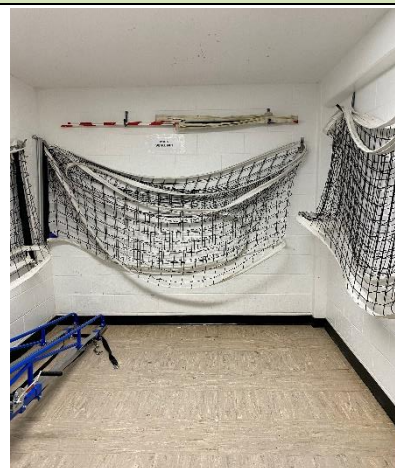
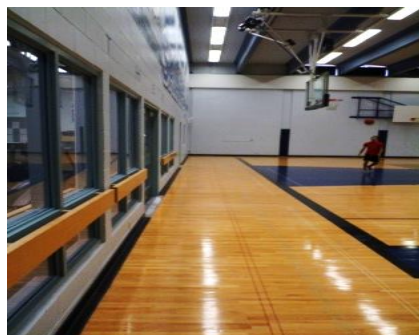

Taken from one corner

Taken from the other corner

Volleyball Equipment Storage

General Information

Parking: There is parking available in the parking lot on the North side of the school. This can only be accessed via 109 St. Southbound, or by turning West onto 110 Ave. and using 110 St. to access the parking lot.

Entrance: Players should enter through the main doors on the Southeast corner of the building. All other doors will be locked for security. Players should leave outdoor footwear at the entrance.

Gym Location: Once inside, turn left into the stairway and go up to the 2nd floor. Once up, go straight and you will arrive at the gym.

Change room/Washroom: Players can change in the washrooms that are located outside the main entrance to the gym, or change in the hallway outside of the gym doors.

Floor: There is a micro-fibre broom in the equipment room that can be used to clear dust and debris from the floor. Use the turquoise lines for Volleyball

Equipment

Sport Specific Equipment Location and details: The basketball hoops should be down when you arrive, the badminton equipment is in the storage room beside the main gym entrance. Volleyball equipment is stored in the storage room on the North side of the gym. There are 3 volleyball nets stored here, please only use the ones labelled North and South.

Gym Set-up

Volleyball

Step 1: Remove the gold post hole covers and insert the poles into the post holes.

Step 2: Attach the top and bottom of the net to the straps on the top and bottom of the poles.

Step 3: Use the cranks to tighten the net. Do not over tighten.

Badminton

Step 1: Remove post hole covers and insert the poles into the post holes. There are 9 posts total.

Step 2: Thread the string on the top of the net through the hole on the top of the pole, then wrap the string onto the hook on the middle of the pole.



www.EdmontonSportsClub.com
17406 106a Ave, Edmonton, AB, T5S 1E6
780.429.GAME(4263)

Step 3: Thread the string on the bottom of the net through the hole on the center of the pole, then wrap the string around the pole and tie the string onto the hook slightly above this hole.

Step 4: Turn the poles to tighten the nets.

Basketball

This gym has regulation glass backboards with break-away rims. There is a 3pt line.

Court Lines: Black basketball court lines easily identifiable in this gym.

Player Benches: Players can sit on the large benches against any wall, outside of the area of play.

Set-up Diagram

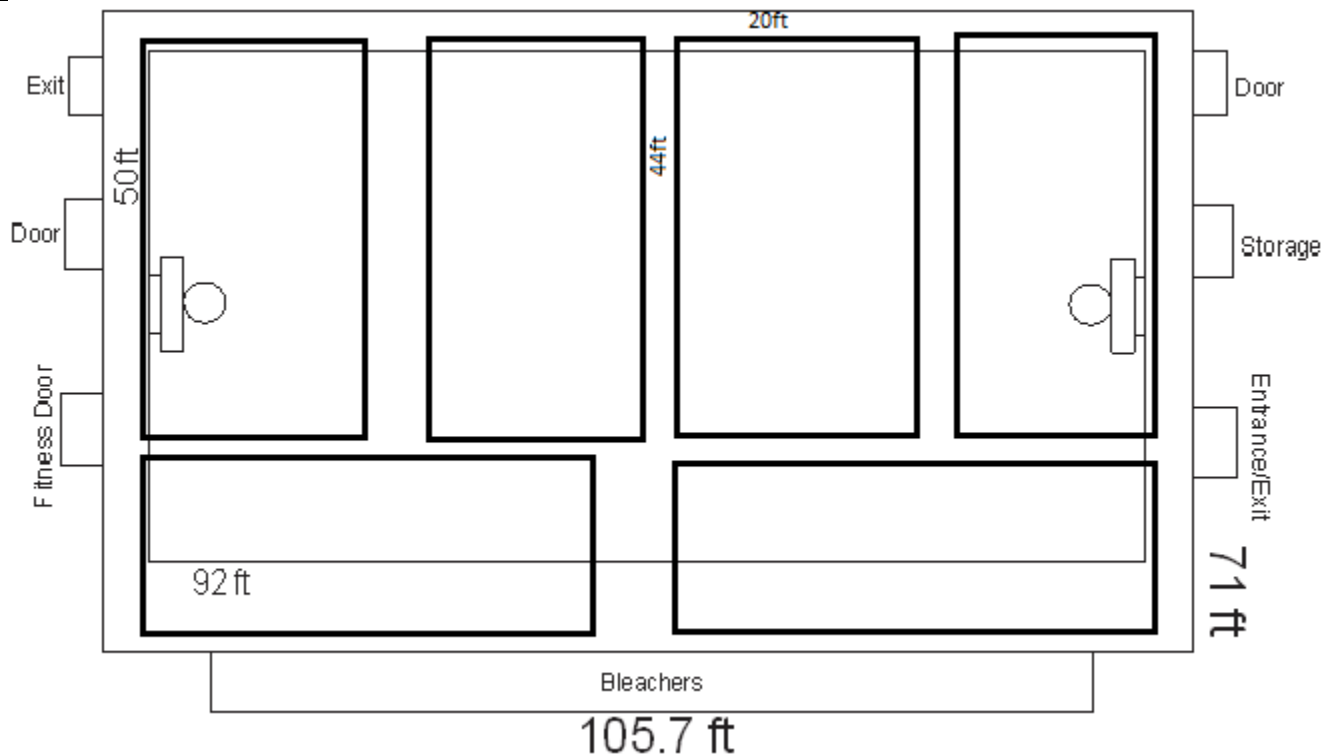

Important Notes

Please do not wander the hallways during games.