

Facility: **St Jeanne D'Arc**

Last Updated: **June 24, 2019**  
Who: **TJ**

Address: 8505 – 68A St. Edmonton, AB T6B 0J9  
Contact/Caretaker:



Photo #1

Photo #2

Photo #3

Photo #4

## General Information

**Parking:** Players may park in the parking lot located on the west side of the school and should use the main entrance. Once inside, the gym is straight down the main hall. Change/washrooms are located in the hall to your right before the gym doors.

**Entrance:** Once inside, the gym is straight down the main hall. Change/washrooms are located in the hall to your right before the gym doors.

**Gym Location:** The gym entrance will be in front of you and to the left through the large blue doors.

**Change room/Washroom:** Washrooms and water fountains are on your right as you enter the building. Players may use those washrooms to change.

**Floor:** The floors are hardwood with a black line for the centre line.

## Equipment

**Sport Specific Equipment Location and details:** Posts and nets are to the left as soon as you walk into the equipment room. Badminton Posts are just under the Volleyball Posts The nets are right beside on the floor.

## Gym Set-up

### Badminton/Pickleball:

**Step 1:** Locate Poles and nets in the gym storage room.

**Step 2:** Insert poles into their proper holes, do not drag them on the floor.

**Step 3:** Clip/tie the top strings onto the top of each post. Then do the same to the bottom. There are no clips for the bottoms so these will need to be tied. Make sure you can untie any knots you make. Do not cut off any string.

**Step 4:** For pickleball follow the same instructions but using the lower holes as the top holes.

### Basketball:

**Court Lines:**

**Player Benches:**



## Set-up Diagram

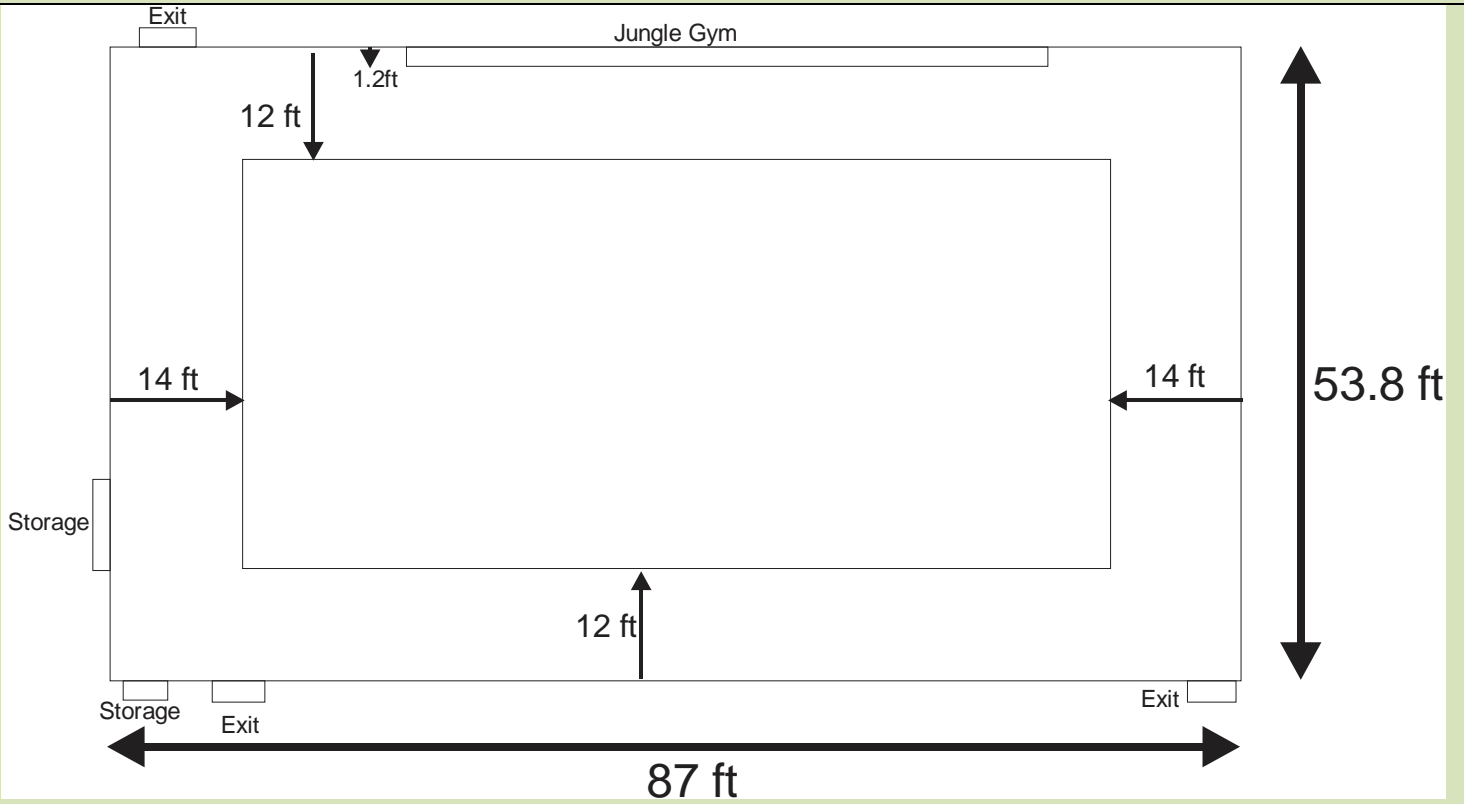

## Important Notes