

Facility: **Sakaw School**

Last Updated: **Jan 16, 2018**
Who: **MB**

Address: **5730 11a Ave.**
Contact/Caretaker: **Bhing Doromal**



Full gym



Court lines



Badminton equipment

General Information

Parking: Players may park in the parking lot located on the West side of the school.

Entrance: Players should enter from the main doors on the South side of the school along 11a Ave. Please leave outdoor footwear at the entrance.

Gym Location: Once in the main doors, go down the hallway on your left. Then the gym door will be on your right.

Change room/Washroom: Players can change in the washrooms that are located along the right hand wall from the gym entrance.

Floor: The floor is an older hardwood, if dusty please ask the custodian for a broom. Badminton lines are white.

Equipment

Sport Specific Equipment Location and details: The Badminton nets and posts can be found in the storage room beside the entrance to the gym.

Gym Set-up

Badminton

Step 1: This is a 2 court setup using 4 posts.

Step 2: Insert the posts into each court and place a net at each court.

Step 3: Thread the string on the top of the net through the hole on the top of the pole, then wrap the string onto the hook on the middle of the pole.

Step 4: Thread the string on the bottom of the net through the hole on the center of the pole, then wrap the string around the pole and tie the string onto the hook slightly above this hole.

Step 5: Turn the poles to tighten the nets.

Set-up Diagram

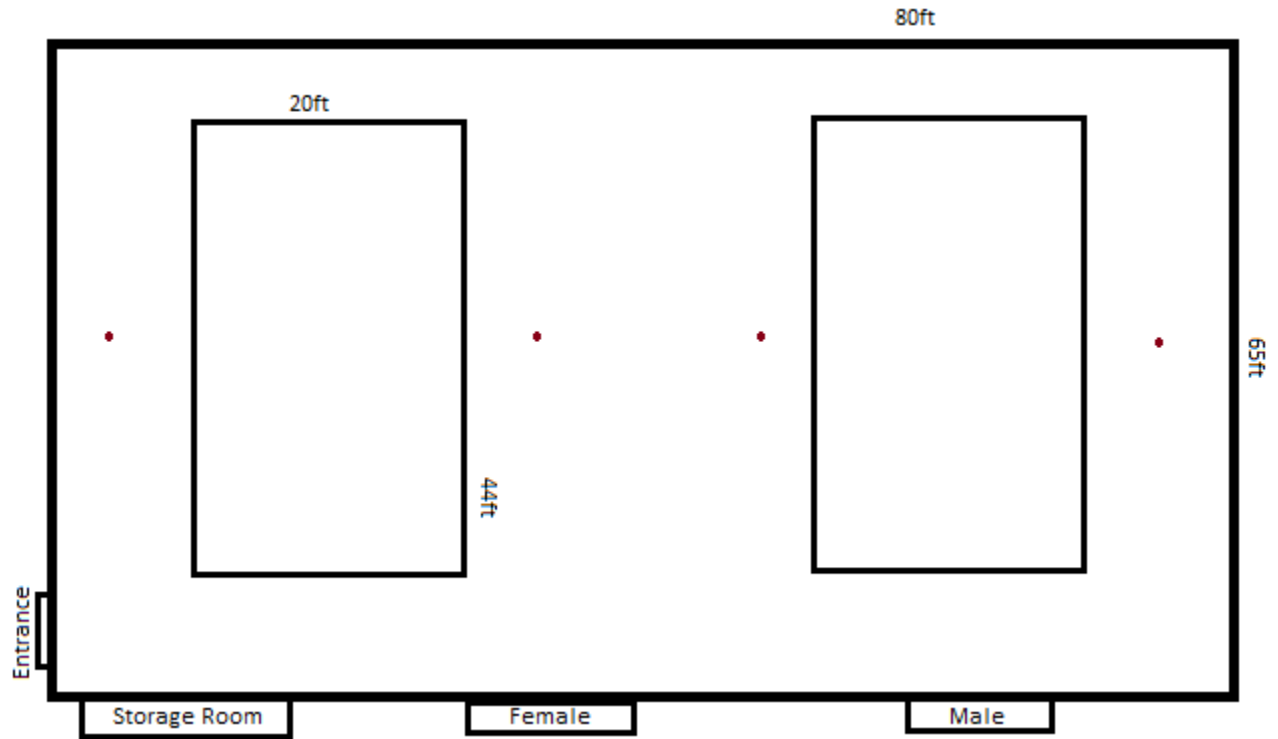

Important Notes

Basketball hoops should be moved to the side when playing badminton.