

Facility: Queen Elizabeth S.H. - East (Small)

Last Updated: Jan 31, 2020
Who: JG

Address: 9425 132 Ave

Contact: Sue West

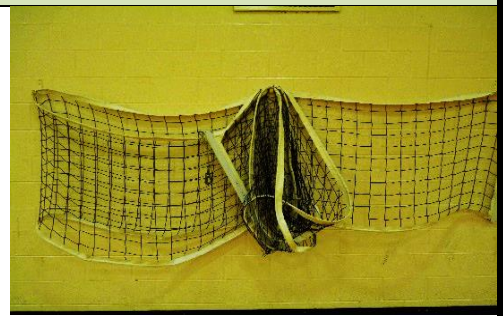

Taken from West baseline

NW corner view

Nets properly hung on North Wall

General Information

Parking: Players can park in front of the school on 95a St.

Entrance: Players should enter from the side entrance on the West side of the building (95a St).
Players should leave outdoor footwear at the entrance.

Gym Location: Once in, if you entered from the West entrance, go down the hall and turn right. This leads to the athletics area and the gym.

Changeroom/Washroom: The female changerooms are located just before the main gym entrance and the male just past the main gym entrance and on your right.

Floor: The floor is newer but has a lot of lines. Use the green lines for volleyball, white for badminton, and black for basketball.

Equipment

Sport Specific Equipment Location and details: The volleyball nets will be on the North wall when you enter the gym. The posts are in the storage room on the North wall to the right of the nets. If basketball nets need to be put up or brought down find the custodian for assistance.

Gym Set-up

Volleyball

Step 1: Take two posts, one with a crank on the bottom and one with the crank on top.

Step 2: Clip the top of the nets to the rope on the post. Ensure that the net is set at the highest setting.

Step 3: The side of the net with the long wire attached is for the post with the top crank. Attach this net to the post and then clip the bottom wire to the other posts rope.

Step 4: Crank the top and bottom cranks until the net is tight and even.

Step 5: Repeat these steps for the other court.

Basketball

Court Lines: Black basketball lines. This gym does have a 3pt line.

Player Benches: Players can stand along the side wall.

The backboard is a small wooden one with a non-breakaway rim. We do not want to use this gym for basketball.



www.EdmontonSportsClub.com
17406 106a Ave, Edmonton, AB, T5S 1E6
780.429.GAME(4263)

Set-up Diagram

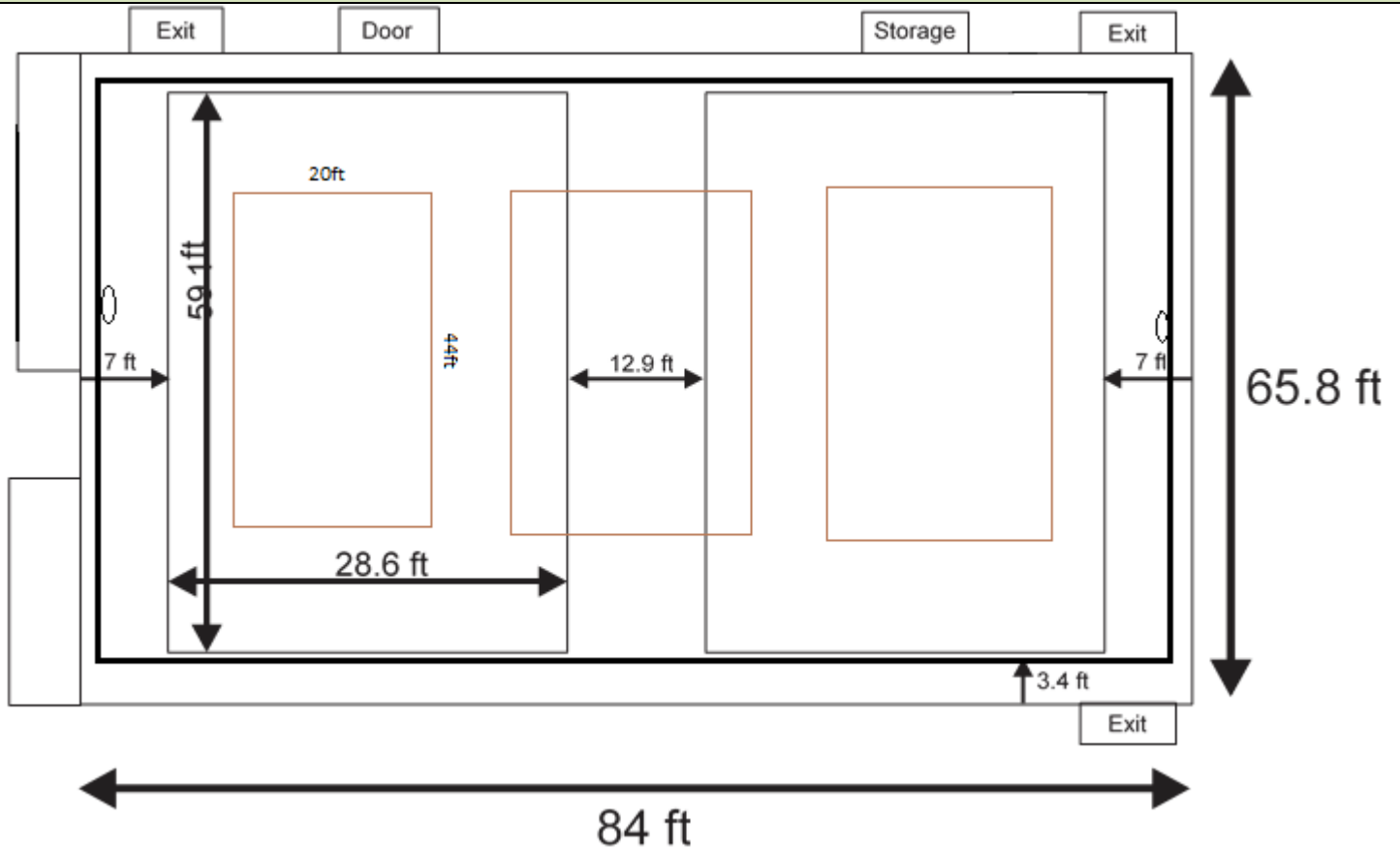

Important Notes

Please do not wander the halls between games.