

Facility: **Mother Margaret Mary H.S.**

Last Updated: **Apr 17, 2018**
Who: **PA**

Address: **2010 Leger Rd NW**
Contact/Caretaker:



Northwest corner of gym

Volleyball setup

Volleyball posts

Volleyball nets

General Information

Parking: Players may park along Leger Rd or in the lot located on the Northeast side of the building

Entrance: Players should enter from the main entrance on the North side of the building. Players should leave outdoor footwear at the entrance.

Gym Location: Inside the entrance you will walk straight ahead and the entrance to the gym will be immediately on your left.

Change room/Washroom: Players can change in the washrooms that are located inside the gym. They can be found on the Northeast side of the gym.

Floor: The floor is a new hardwood. Volleyball lines are red, Basketball lines are black, and Badminton lines are white.

Equipment

Sport Specific Equipment Location and details: The Volleyball and Badminton equipment can all be found in the equipment room. The Basketball nets should be lowered by the custodian if we are playing Basketball there. They should be raised if we are playing Volleyball. Two of the Volleyball posts have red pulleys which go together. The other two posts have blue pulleys that go together.

Gym Set-up

Volleyball

Step 1: Insert poles into holes with the red pulley posts being paired on the same court and the blue pulley posts being paired on the other court.

Step 2: Take the nets and clip them onto the top loops of the posts.

Step 3: Take the bottom of the nets and clip them to the bottom loops.

Step 4: Once the nets are clipped onto the posts and pulleys, crank them to tighten the nets. Do not over tighten

Step 5: Repeat steps 2-4 on each court.

Basketball

Court Lines: Black basketball court lines easily identifiable in this gym. This gym has a 3 point line and glass backboards.

Player Benches: Players can sit on the large benches against any wall, outside of the area of play.

Badminton

Step 1: Remove post hole covers and insert the poles into the post holes. 4 posts in total.

Step 2: Thread the string on the top of the net through the hole on the top of the pole, then wrap the string onto the hook on the middle of the pole.

Step 3: Thread the string on the bottom of the net through the hole on the center of the pole, then wrap the string around the pole and tie the string onto the hook slightly above this hole.

Step 4: Turn the poles to tighten the nets.

Set-up Diagram

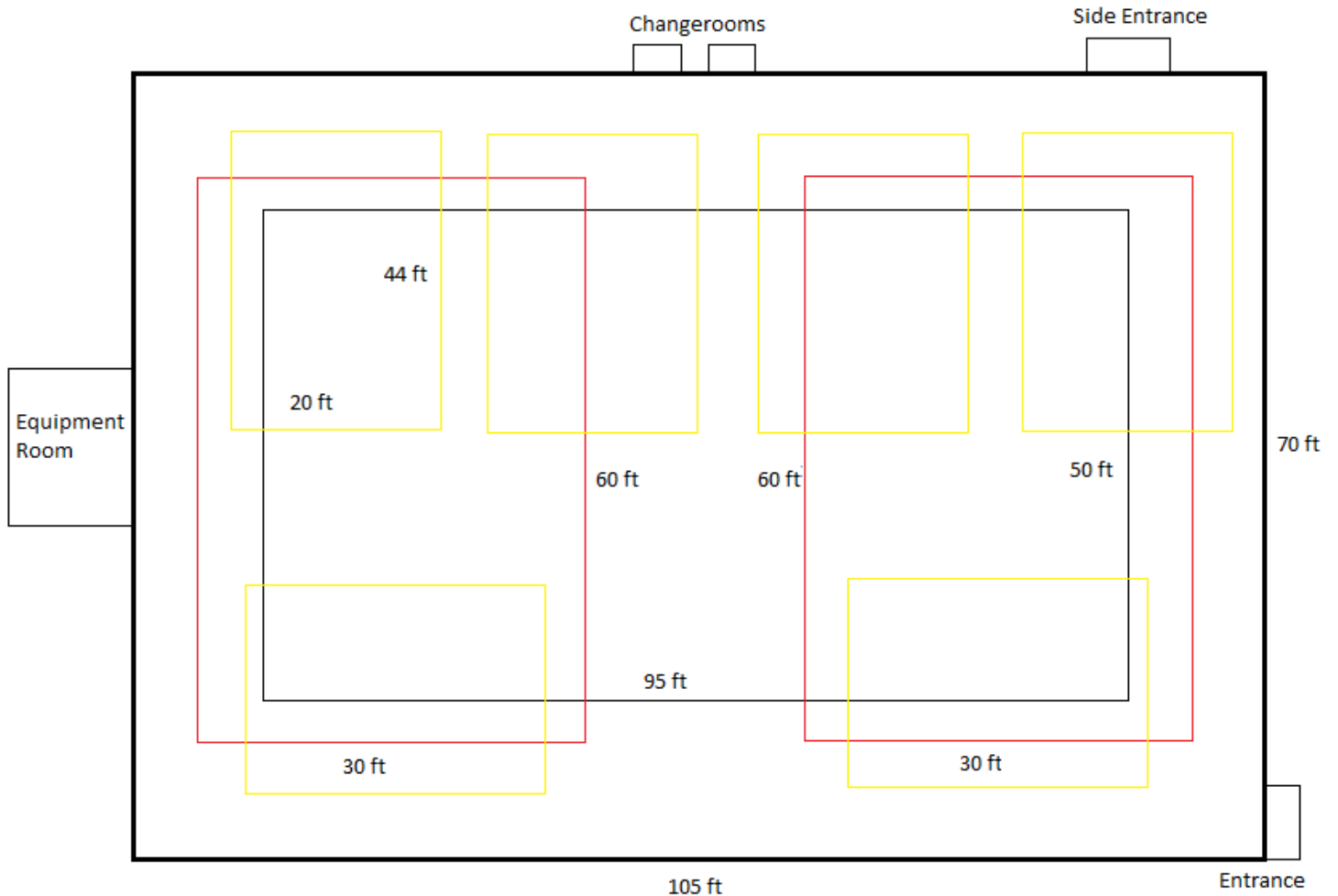

Important Notes