

Facility: **Donald R. Getty**

Last Updated: **Oct 4, 2018**
Who: **PA**

Address: **8102 Chappelle Way SW**
Contact/Caretaker:



Taken from Southwest corner

Taken from Northeast corner

Volleyball posts

Volleyball nets

General Information

Parking: Players may park in the parking lot on the South side of the school.

Entrance: Players should enter from the main entrance on the South side of the school.

Gym Location: Inside the entrance turn right and the gym doors will be directly in front of you.

Change room/Washroom: Players can change in the washrooms that are located inside the gym.

Floor: The floor is a hardwood floor. Basketball lines are black, Volleyball lines are dark green.

Equipment

Sport Specific Equipment Location and details: The Volleyball equipment can be found in the storage room in the Northwest corner of the gym.

Gym Set-up

Volleyball / Badminton

Step 1: Choose one post with a square crank on it and one without. Place the posts on opposite sides of the court.

Step 2: The net height is adjustable on each post – set it so that 5 holes are showing by sliding the sleeve and replacing the pin.

Step 3: Thread the rope from the net over the pulley, towards the crank and attach. Attach net to opposite post by threading rope over the pulley and placing loop over hook.

Step 4: Attach the bottom of the nets to the bottom of the posts.

Step 5: Tighten the net on the top of the net using the crank wheel. Do NOT over-tighten.

Basketball

Court Lines: Black basketball court lines easily identifiable in this gym.

Player Benches: Players can sit on the benches against any wall, outside of the area of play.

Set-up Diagram

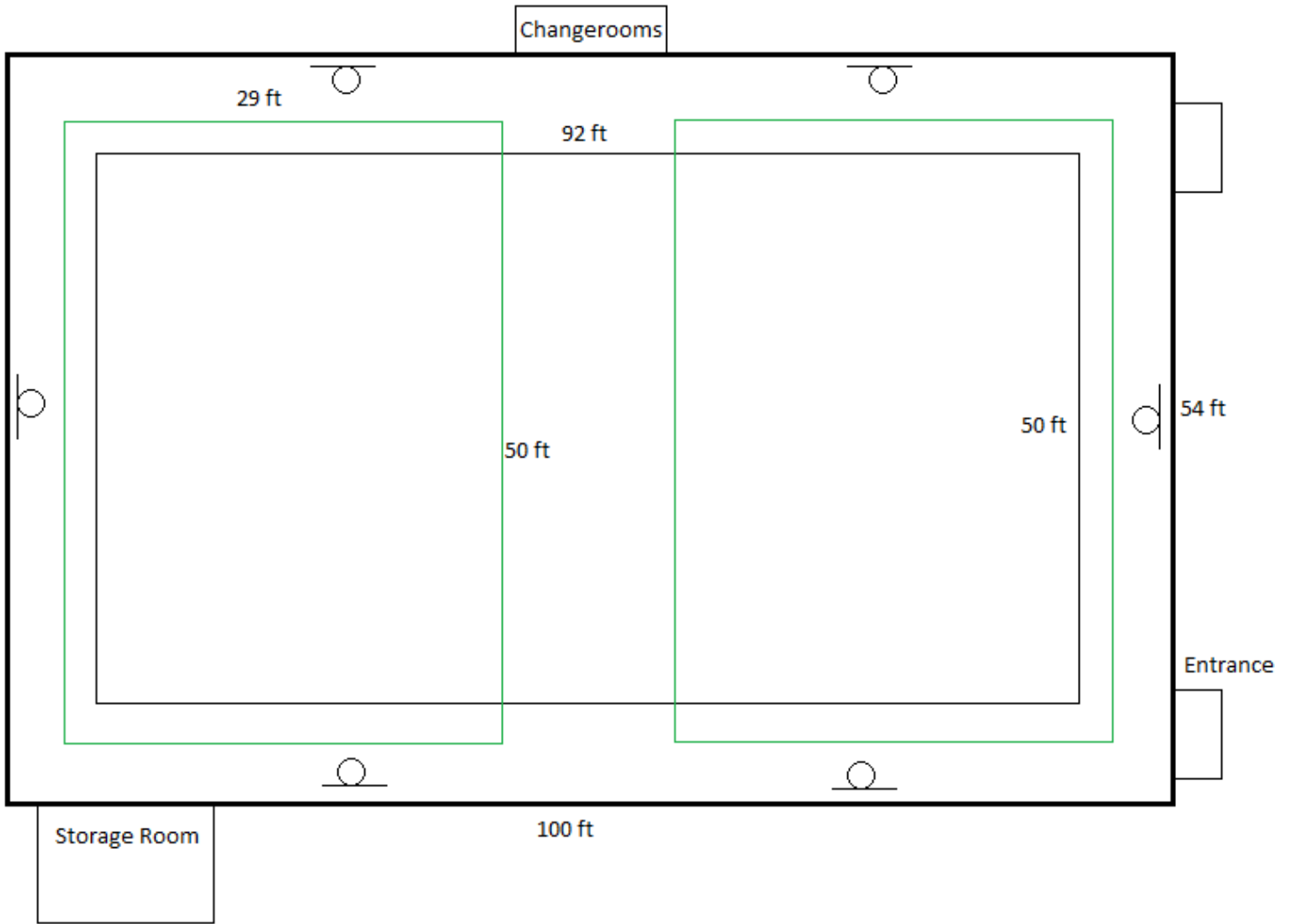

Important Notes