

Facility: **A la Decouverte**

Last Updated: **Oct 13, 2023**  
Who: **LC**

Address: **17610 106 St. NW**

Contact/Caretaker: **Serge**



School Entrance



Gym



Equipment Setup



Badminton Poles

## General Information

**Parking:** Players can park in the East parking lot off 104 St.

**Entrance:** Players should enter through the East doors. If doors are locked, please ring the after-hours doorbell. After that, players will need to monitor the door and let players into the building. Do NOT use the left door labelled "CEPP".

**Gym Location:** Once inside, the gym is located on the right. The gym entrance is straight ahead and on the right.

**Changeroom/Washroom:** Washrooms are located inside the gym on West wall.

**Floor:** This school has a hardwood floor. For badminton, use the white lines. This school has 4 badminton courts.

## Equipment

**Sport Specific Equipment Location and details:** The storage room is along the West wall in the far corner. Both nets and poles are located in here. Badminton poles are located behind the door. If this door is locked, please find the custodian to unlock it.

## Gym Set-up

### **Badminton/Pickleball:**

**Step 1:** Setup the blue badminton posts into the respective holes on either side of the court.

**Step 2:** Attach the net to the rings on both poles.

**Step 3:** Twist the poles to tighten if needed.



[www.EdmontonSportsClub.com](http://www.EdmontonSportsClub.com)  
17406 106a Ave, Edmonton, AB, T5S 1E6  
780.429.GAME(4263)

## Set-up Diagram

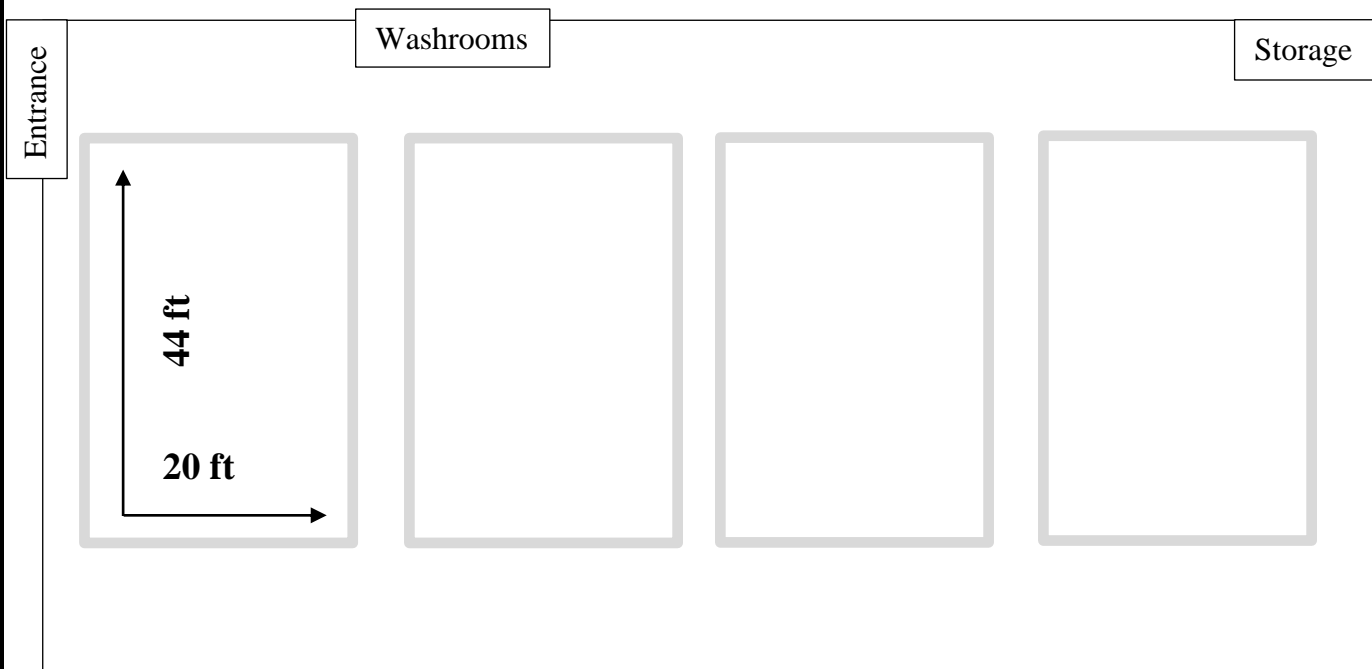

## Important Notes

- Do not prop open any doors.
- Do not wander the halls.